

Heatshrinkable moulded shapes bulbous End Caps - HellermannTyton

DRAWING No.
152189

SHT. 1
OF
1 SHTS.

© THE COPYRIGHT OF THIS DRAWING IS RESERVED BY HELLERMANN TYTON. IT IS ISSUED ON CONDITION THAT IT IS NOT COPIED, REPRODUCED OR DISCLOSED TO A THIRD PARTY EITHER WHOLLY OR IN PART WITHOUT THE CONSENT IN WRITING OF HELLERMANN TYTON.

THIRD ANGLE PROJECTION

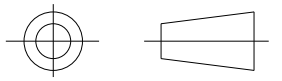

BS 8888

DO NOT SCALE
IF IN DOUBT ASK

Q.A.	H/S SETT
H/S Q.A.	REL. INSP.
H/S PROD	EXT.ISS.CODE 8

STANDARD PART (AFTER UNRESTRICTED RECOVERY)

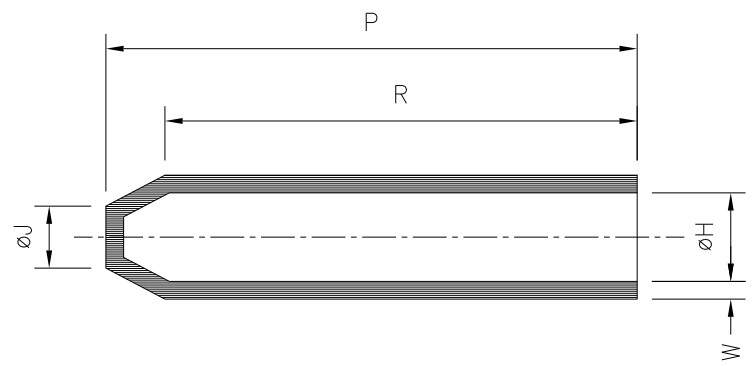

EXPANDED (AS SUPPLIED)

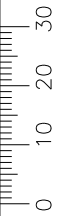
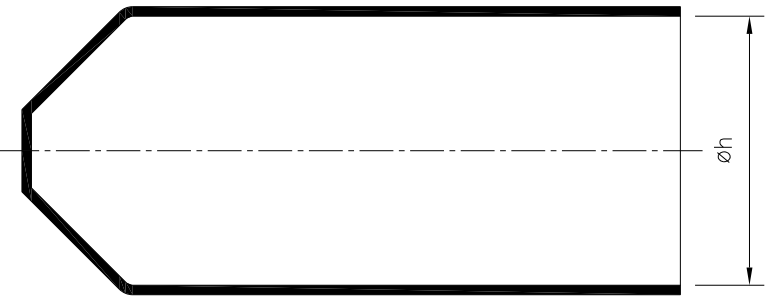

PART NO.	EXPANDED DIMENSIONS (AS SUPPLIED)	RECOVERED DIAMETERS		RECOVERED DIMENSIONS			
		h	øH	øJ	P	R	W
		MIN	MAX	MAX	±10%	±10%	±20%
1601-1	23.8 (0.94)	9.4 (0.37)	7.4 (0.29)	88.9 (3.50)	85.5 (3.37)	2.0 (0.08)	

Heatshrinkable moulded shapes bulbous End Caps - HellermannTyton

For information only, not subject to technical changes.

1	P1256	L.F.	09/02/09
ISSUE	NOTE No.	DRAWN	DATE

HellermannTyton

Pennycross Close, Plymouth, Devon, England
Tel ++44 (0) 1752 701261 Fax ++44 (0) 1752 790058

NAME	L.F.	SCALE	NTS
DATE	09/02/09	DIMS IN	mm (in)
TITLE END CAP			

ADHESIVE	A3	SHT. 1
	ORIGINAL SHEET SIZE 420mm x 297mm	OF 1 SHTS.
PART No.	1601	DRAWING No.
		152189