

Heatshrinkable moulded shapes bulbous End Caps - HellermannTyton

DRAWING No.  
152192

SHT. 1  
OF  
1 SHTS.

© THE COPYRIGHT OF THIS DRAWING IS RESERVED BY HELLERMANN TYTON. IT IS ISSUED ON CONDITION THAT IT IS NOT COPIED, REPRODUCED OR DISCLOSED TO A THIRD PARTY EITHER WHOLLY OR IN PART WITHOUT THE CONSENT IN WRITING OF HELLERMANN TYTON.

THIRD ANGLE PROJECTION

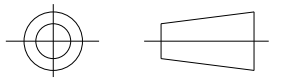

BS 8888

DO NOT SCALE  
IF IN DOUBT ASK

Q.A.	H/S SETT
H/S Q.A.	REL. INSP.
H/S PROD	EXT.ISS.CODE 8

STANDARD PART (AFTER UNRESTRICTED RECOVERY)

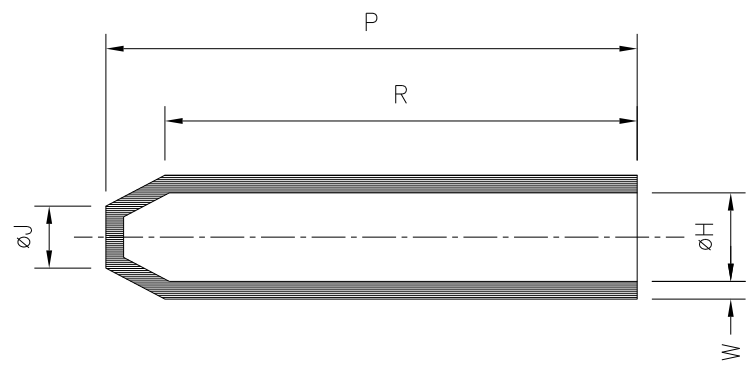

EXPANDED (AS SUPPLIED)

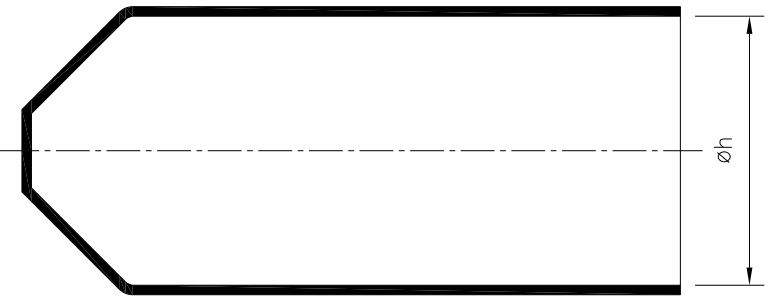

PART NO.	EXPANDED DIMENSIONS (AS SUPPLIED)	RECOVERED DIAMETERS		RECOVERED DIMENSIONS			
		h	øH	øJ	P	R	W
		MIN	MAX	MAX	±10%	±10%	±20%
1609-1	120.0 (4.72)	60.0 (2.36)	17.0 (0.67)	150.0 (5.91)	133.0 (5.24)	4.0 (0.16)	

Heatshrinkable moulded shapes bulbous End Caps - HellermannTyton

For information only, not subject to technical changes.

1	P1256	L.F.	09/02/09
ISSUE	NOTE No.	DRAWN	DATE

**HellermannTyton**

Pennycross Close, Plymouth, Devon, England  
Tel ++44 (0) 1752 701261 Fax ++44 (0) 1752 790058

NAME	L.F.	SCALE	NTS
DATE	09/02/09	DIMS IN	mm (in)
TITLE END CAP			

ADHESIVE	A3	SHT. 1
	ORIGINAL SHEET SIZE 420mm x 297mm	OF 1 SHTS.
PART No.	1609	DRAWING No.
		152192