

Heatshrinkable moulded shapes bulbous 2-Way Outlet Shapes, VG style - HellermannTyton

DRAWING No.
152034

SHT. 1
OF
1 SHTS.

© THE COPYRIGHT OF THIS DRAWING IS RESERVED BY HELLERMANN TYTON. IT IS ISSUED ON CONDITION THAT IT IS NOT COPIED, REPRODUCED OR DISCLOSED TO A THIRD PARTY EITHER WHOLLY OR IN PART WITHOUT THE CONSENT IN WRITING OF HELLERMANN TYTON.

THIRD ANGLE PROJECTION

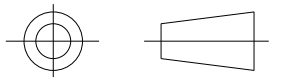

BS 8888

DO NOT SCALE
IF IN DOUBT ASK

Q.A.	H/S SETT
H/S Q.A.	REL. INSP.
H/S PROD	EXT.ISS.CODE 2



STANDARD PART (AFTER UNRESTRICTED RECOVERY)

EXPANDED (AS SUPPLIED)

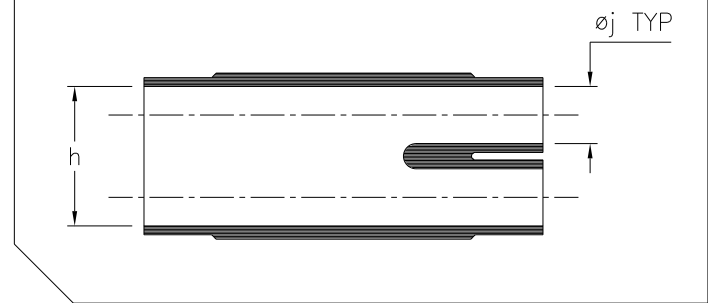
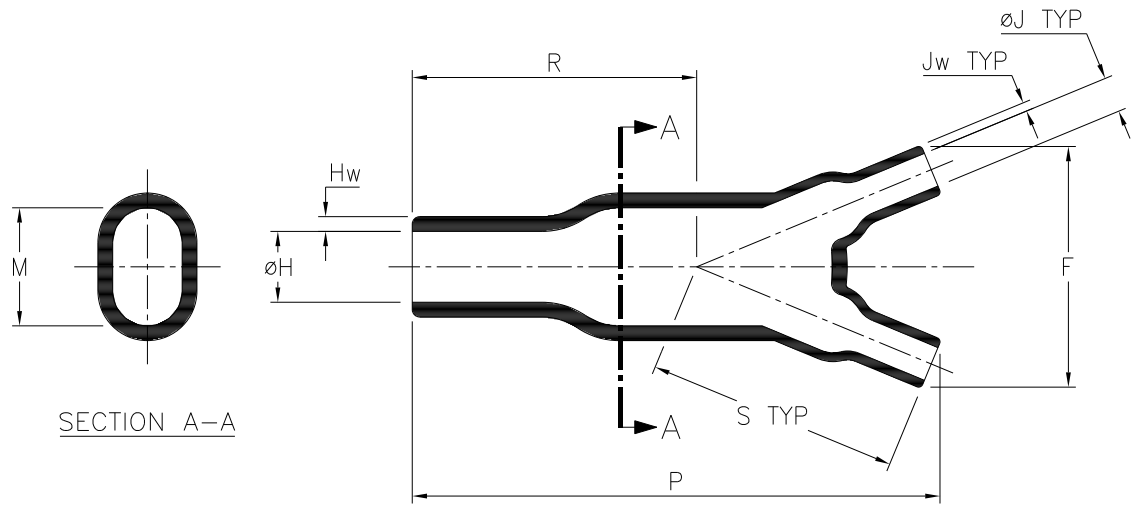

SECTION A-A

SPEC.	PART NO.	EXPANDED DIMENSIONS (AS SUPPLIED)		RECOVERED DIAMETERS		RECOVERED DIMENSIONS						
		h	øj	øH	øJ	F	M	P	R	S	Hw	Jw
		MIN	MIN	MAX	MAX	±15%	MAX	±15%	NOM	NOM	±30%	±30%
VG 95343 T08C003A	204-1	39.0 (1.54)	27.0 (1.06)	18.0 (.71)	12.0 (.47)	74.0 (2.91)	35.0 (1.38)	131.0 (5.16)	66.0 (2.60)	81.0 (3.19)	3.0 (.12)	2.5 (.10)

Heatshrinkable moulded shapes bulbous 2-Way Outlet Shapes, VG style - HellermannTyton

For information only, not subject to technical changes.

1	P1185	S.Almond	26/03/08
ISSUE	NOTE No.	DRAWN	DATE

HellermannTyton

Pennycross Close, Plymouth, Devon, England
Tel ++44 (0) 1752 701201 Fax ++44 (0) 1752 790058

NAME	S.Almond	SCALE	NTS	ADHESIVE	A3 ORIGINAL SHEET SIZE 420mm x 297mm	SHT. 1 OF 1 SHTS.
DATE	26/03/08	DIMS IN	mm (in)			
TITLE	2 WAY OUTLET SLEEVE		PART No.	204	DRAWING No.	152034