



GST Modular Panels

1U 24 Port, 1U 48 Port, 2U 48 Port and 2U 72 Port

Application/Product Description

A range of modular patch panels which is comprised of flat and angled panels in 2U 72, 2U 48, 1U 48 or 1U 24 ports. All panels have a labelling field for each jack.

All patch panels are supplied without jacks (unloaded) and are supplied with either Rack Snaps, Cage Nuts, 12-24 rack Screws or without fixings. All panels are compatible with the HellermannTyton range of Category 6A, 6 and 5e GST jacks.

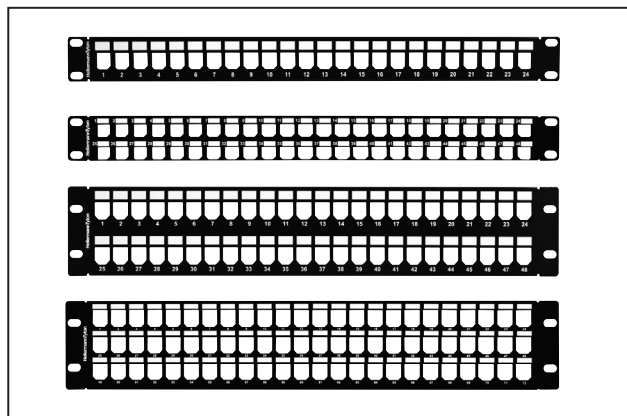

GST Modular Flat Panels

Technical Data

Specification	Flat Panels											
Port Density	1U 24 Port			1U 48 Port			2U 48 Port			2U 72 Port		
Dimensions (mm)	H	W	D	H	W	D	H	W	D	H	W	D
	44.0	483.0	11.0	44.0	483.0	11.0	88.0	483.0	11.0	88.0	483.0	11.00
Panel Weight (g)	500			300			800			700		

Material	
Panel	Mild Steel, Black Powder Coated

Technical Diagrams

1U 24 Port

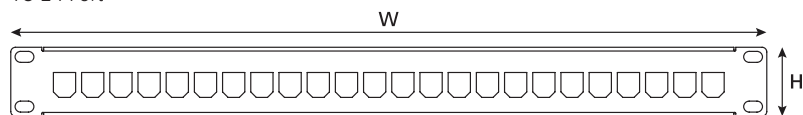

Front view

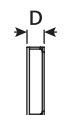

Side view



Top view

1U 48 Port

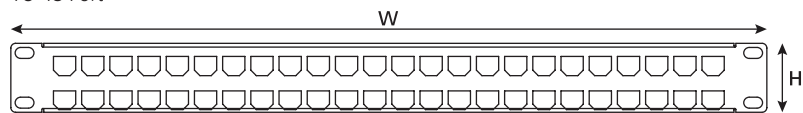

Front view

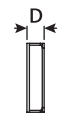

Side view



Top view

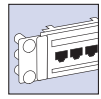

2U 48 Port

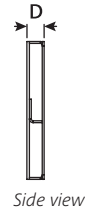
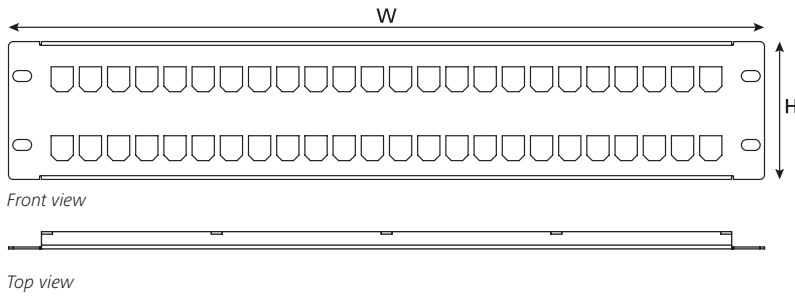

2U 72 Port

