

REFERENCE:

PERFORMANCE REQUIREMENTS AT DRY AS MOLDED:

1. FIR TREE PUSH IN FORCE: REF. 15 LBS MAX IN A 9.0mm X 17mm OVAL HOLE AND A PLATE THICKNESS OF 1.8mm
2. FIR TREE PULL OUT FORCE: REF. 40 LBS MIN IN A 9.0mm X 17mm OVAL HOLE AND A PLATE THICKNESS OF 1.8mm
3. SHEET METAL THICKNESS RANGE: 0.60mm - 15.5mm

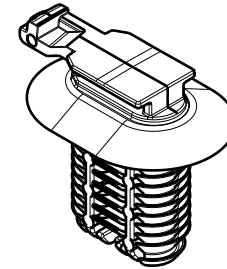
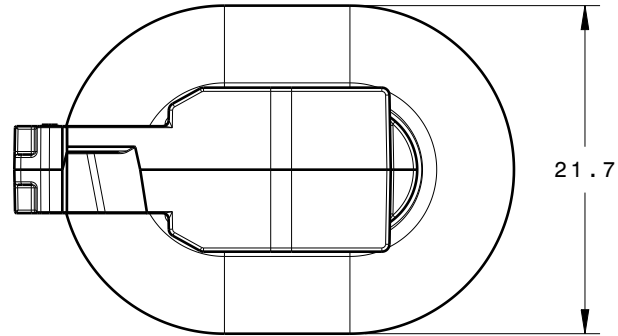

Isometric view

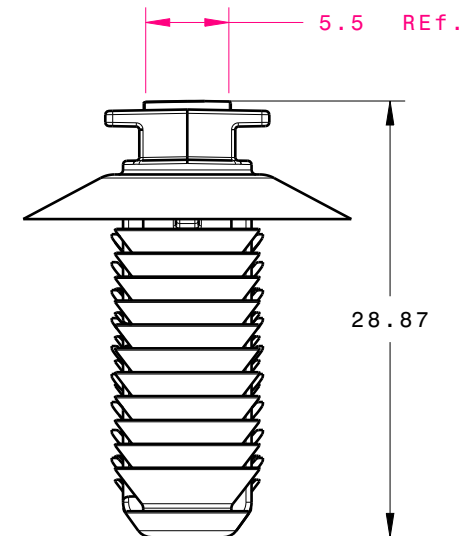
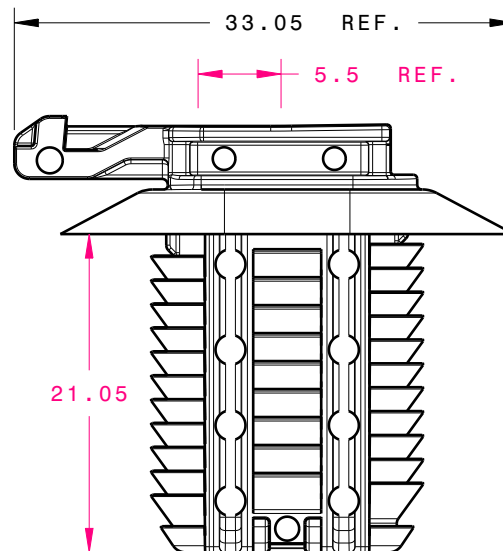

IN  
V  
E  
N  
T  
O  
R  
S

**HellermannTyton®**

ALL PROPRIETARY RIGHTS IN THE SUBJECT MATTER SHOWN ON THIS DRAWING ARE EXCLUSIVE PROPERTY OF HELLERMANN TYTON

name	date	city, state
S. ADAMS	9/25/09	MENOMONEE FALLS, WI.

REVISIONS	DRAWING
02	level
SJA	by
12/10/09	date
011446	ECN #
A	part level

DIMENSIONS	TOLERANCES
	.XXXX = ± 0.25
	.XXX = ± 0.50
	.XX = ± 1.00
	.X = ± 2.00
	∠ = ± 0.50
	unless otherwise specified
	units millimeters

PART	number	phase
	CC10	PRODUCTION
	name	
	9 X 17mm EXTENDED FIR TREE CONNECTOR CLIP	
	material	
	NYLON 6/6 IMPACT MODIFIED, HEAT STABILIZED, UV RESISTANT	
	COLOR: BLACK	

DRAWING	FORMAT	VERSION	CAD	SCALE
	AH	J	CATIA V5	1:1
	A-SIZE (landscape) N01			
	S. ADAMS	A. CLARK		
	9/25/09	9/25/09		
	CUSTOMER	sheet 1 of 1		
	MT09-0478-001CST			