

CATIA V5

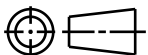

Revision Level		Revision Record	Changed	Date	Approved	Date
Drawing	Part					
02.01	A	SEE ECN# 012471	SJA	10/8/13	KVH	10/8/13

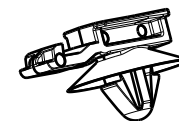
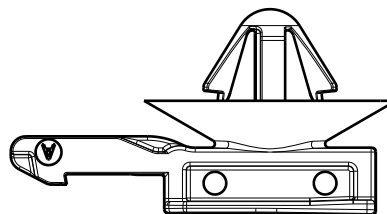

ISOMETRIC VIEW
SCALE 1:1

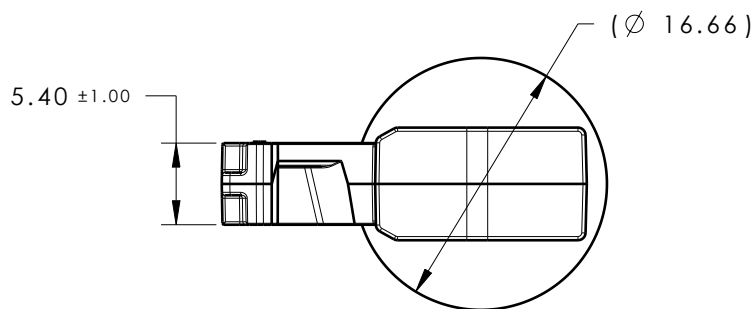

REFERENCE:

PERFORMANCE REQUIREMENTS AT DRY AS MOLDED:

1. PUSH IN FORCE: 45 NEWTONS (10 LBS) MAX IN THE APPLICABLE NOMINAL HOLE SIZE AND A PLATE THICKNESS OF 0.8mm.
2. PULL OUT FORCE: 90 NEWTONS (20 LBS) MIN IN THE APPLICABLE NOMINAL HOLE SIZE AND A PLATE THICKNESS OF 0.8mm. 02
3. SHEET METAL THICKNESS RANGE: 0.65mm - 1.40mm
4. APPLICABLE HOLE SIZE:
A. 5.35mm +/- 0.35
5. DESIGNED TO MEET INSERTION/EXTRACTION FORCES OF SAE/USCAR-2 REVISION 5 (PAGE 45)
6. FITS INTO USCAR CLIP SLOT SPECIFICATION EWCAP-005-7 (NOT A TEST SPEC.)

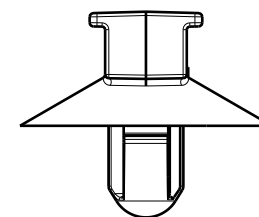
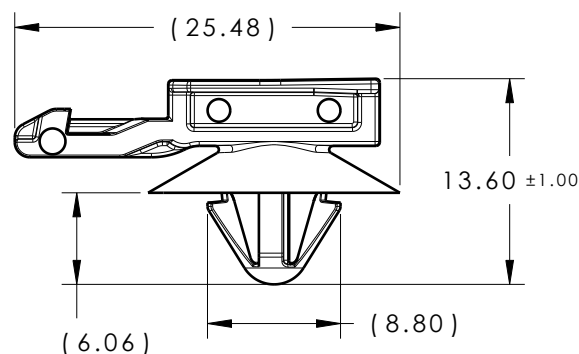

Material PA66HIRHS COLOR: NATURAL 02	Units millimeters Tolerance defined on each dimension	The copyright of this drawing is reserved by HellermannTyton. It is issued on condition that it is not reproduced, copied or disclosed to a third party, either wholly or in part, without the consent of HellermannTyton.	Drawn	KVH	1/29/13	Article/Type-No	CC14	Scale	2:1
			Approved	SJA	6/17/13	Title	EWCAP-005-7 CONNECTOR CLIP WITH 5.35mm ARROWHEAD	Project Number	13-0217
			HellermannTyton North America Email: corp@htamericas.com Web: www.hellermann.tyton.com			Drawing-No	PRODUCTION : Phase	Format	AH
						13-0217-011-CSU		Sheet	1/1