

CATIA V5

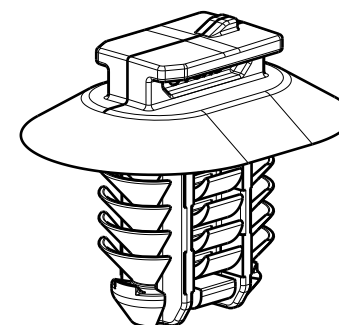

Revision Level		Revision Record	Changed	Date	Approved	Date
Drawing	Part					
03.1	A	SEE ECN# 311348	SAR	07/22/24	EJH	07/22/24

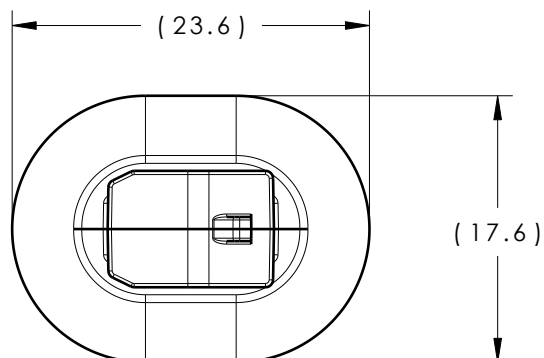

ISOMETRIC VIEW

REFERENCE:

PERFORMANCE REQUIREMENTS AT DRY AS MOLDED:

1. FIR TREE PUSH IN FORCE: 45 NEWTONS (10 LBS) MAX IN EACH APPLICABLE OVAL HOLE SIZE AND A PLATE THICKNESS OF 1.8mm.
2. FIR TREE PULL OUT FORCE: 110 NEWTONS (25 LBS) MIN IN EACH APPLICABLE OVAL HOLE SIZE AND A PLATE THICKNESS OF 1.8mm.
3. SHEET METAL THICKNESS RANGE: 0.60mm - 6.75mm
4. APPLICABLE OVAL HOLE SIZES:
 - A. 6.2 X 12.2mm
 - B. 6.5 X 12.5mm
 - C. 6.5 X 13.0mm
 - D. 7.0 X 12.0mm

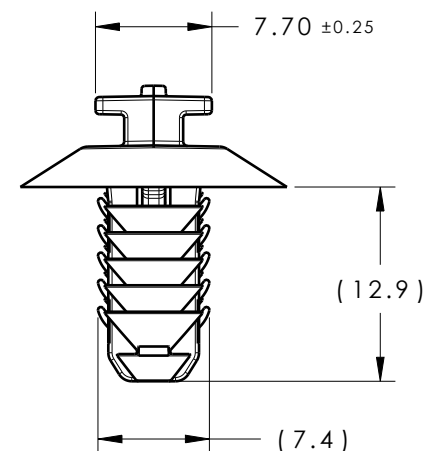
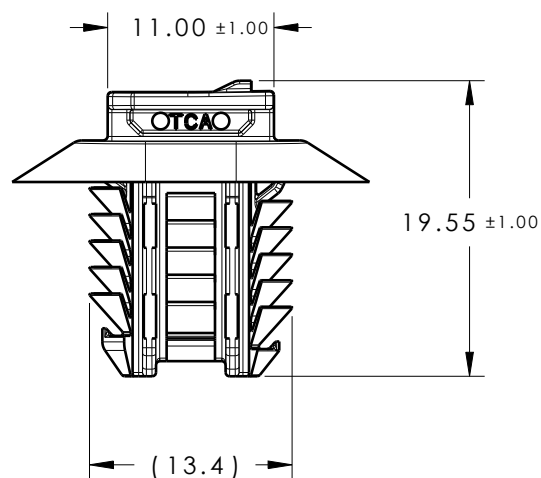

Material
PA66HIRHSUV
COLOR: BLACK



Units millimeters

Tolerance defined on each dimension

The copyright of this drawing is reserved by HellermannTyton. It is issued on condition that it is not reproduced, copied or disclosed to a third party, either wholly or in part, without the consent of HellermannTyton.

Drawn MHT 04/26/13
Approved SJA 04/26/13

HellermannTyton

North America
Email: corp@htamericas.com
Web: www.hellermann.tyton.com

Article/Type-No CCOVAL5

Title
OVAL FIR TREE WITH TYCO CONNECTOR
SLOT

Drawing-No PRODUCTION : Phase

13-0523-001-CSU

Scale 2:1

Project Number
13-0523

Format AH

Sheet 1/1