

CATIA V5



REFERENCE:

PERFORMANCE REQUIREMENTS AT DRY AS MOLDED:

1. FIR TREE PUSH IN FORCE: 45 NEWTONS (10 LBS) MAX
IN THE APPLICABLE NOMINAL HOLE SIZE AND A
PLATE THICKNESS OF 1.8mm.
2. FIR TREE PULL OUT FORCE: 110 NEWTONS (25 LBS) MIN
IN THE APPLICABLE NOMINAL HOLE SIZE AND A
PLATE THICKNESS OF 1.8mm.
3. SHEET METAL THICKNESS RANGE: 0.60mm - 8.25mm
4. APPLICABLE HOLE SIZE:
A. 6.5mm +/- 0.4
B. 6.35mm +/- 0.25 HEX

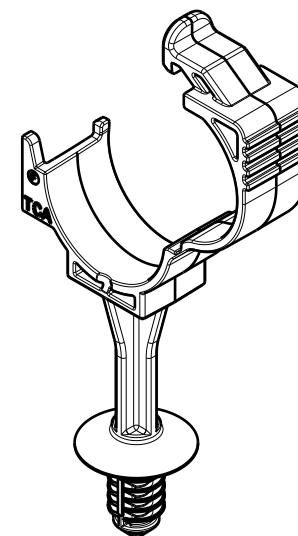
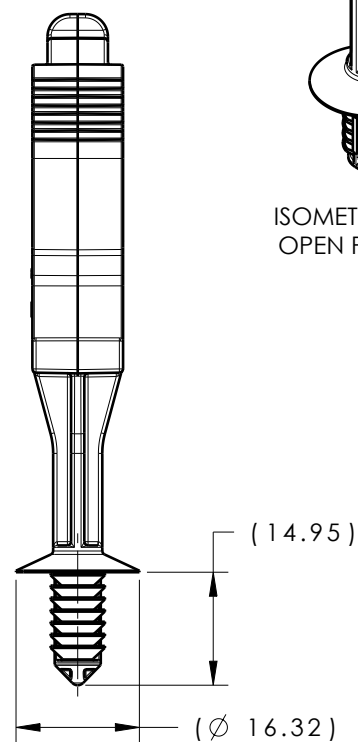
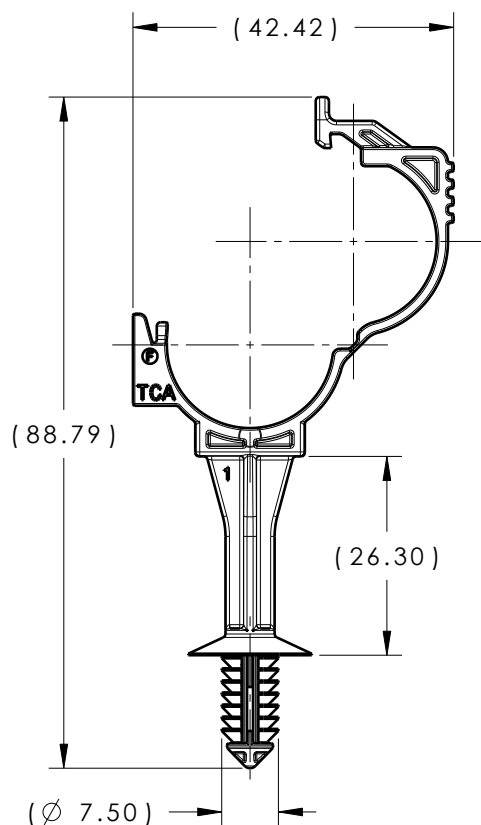
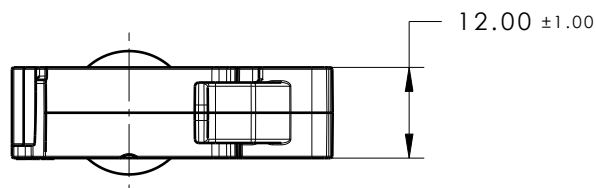
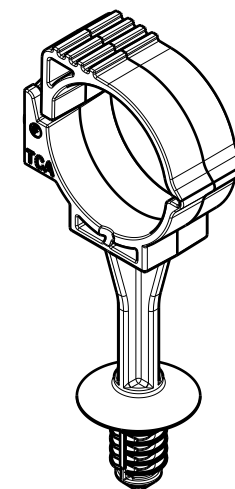
ISOMETRIC VIEW
OPEN POSITIONISOMETRIC VIEW
CLOSED POSITION

Material
PA66HIRHSUV
COLOR: BLACK



Units millimeters

Tolerance defined on
each dimension

The copyright of this
drawing is reserved by
HellermannTyton. It is
issued on condition that it is
not reproduced, copied or
disclosed to a third party,
either wholly or in part,
without the consent of
HellermannTyton.

Drawn KVH 7/11/13
Approved EJH 12/18/13

HellermannTyton

North America
Email: corp@htamericas.com
Web: www.hellermann.tyton.com

Article/Type-No LOC15-19FT6LGSO

Title 26mm STAND OFF LOCKING OMEGA CLIP
(15 TO 19mm BUNDLE) WITH FT6 FIR
TREE

Drawing-No PRODUCTION : Phase

13-0558-011-CSU

Scale 1:1

Project Number
13-0558

Format AH

Sheet 1/1