

CATIA V5

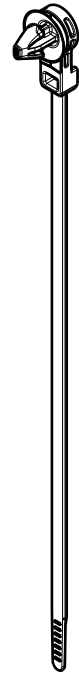
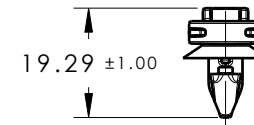
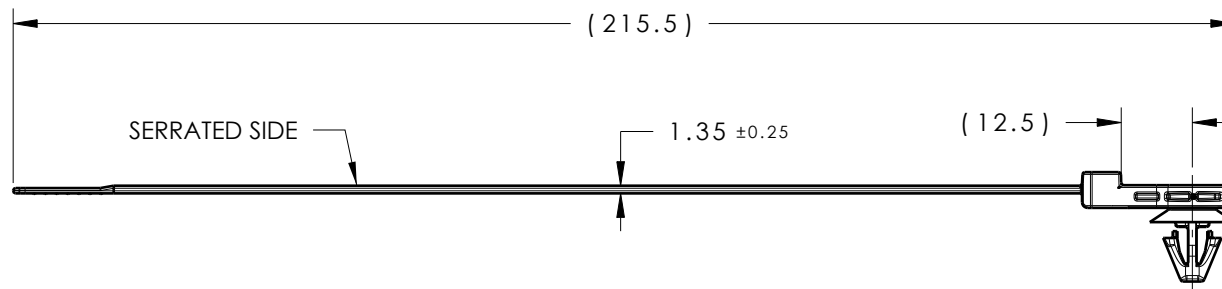
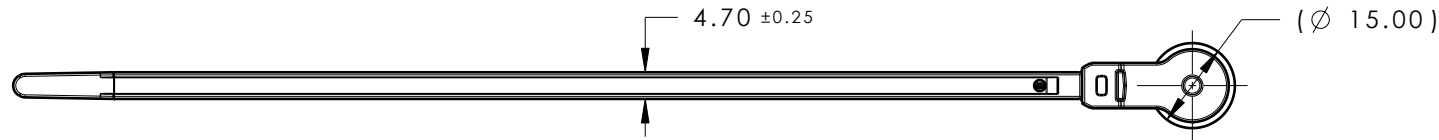
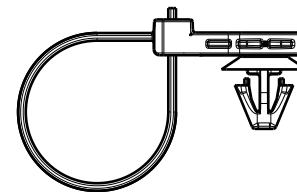

Revision Level			Revision Record	Changed	Date	Approved	Date
Drawing	State	Part					
01.1	Design Release	B	SEE ECN# 311356	SAR	07/23/24	EJH	07/23/24

ISOMETRIC VIEW
SCALE 1:2

ASSEMBLY VIEW

PERFORMANCE REQUIREMENTS AT DRY AS MOLDED:

1. ARROWHEAD PUSH IN FORCE: 45 NEWTONS (10 LBS) MAX IN THE APPLICABLE NOMINAL HOLE SIZE AND A PLATE THICKNESS OF 2.3mm.
2. ARROWHEAD PULL OUT FORCE: 110 NEWTONS (25 LBS) MIN IN THE APPLICABLE NOMINAL HOLE SIZE AND A PLATE THICKNESS OF 2.3mm.
3. SHEET METAL THICKNESS RANGE: 1.80mm - 2.80mm
4. APPLICABLE HOLE SIZE:
 - A. 6.5mm +/- 0.4
 - B. 6.35mm +/- 0.25 HEX
5. CABLE TIE MIN LOOP TENSILE STRENGTH: 225 NEWTONS (50 LBS)
6. BUNDLE RANGE: 2.0mm TO 50.0mm

PRODUCT NUMBER CROSS REFERENCE RECORD

TYPE NUMBER	UNS-UNIVERSAL NUMBER SYSTEM
T50ROSFT6.35SO12.5B	157-00246

Material
PA66HIRHSUV
COLOR: BLACK



Units millimeters

Tolerance defined on
each dimension

The copyright of this drawing is reserved by HellermannTyton. It is issued on condition that it is not reproduced, copied or disclosed to a third party, either wholly or in part, without the consent of HellermannTyton.

Drawn KVH 5/22/15

Approved CJR 6/25/15

HellermannTyton

North America
Email: corp@htamericas.com
Web: www.hellermann.tyton.com

Article/Type-No SEE CHART

Title T50ROS WITH 12.5mm OFFSET AND
6.35mm HEX HOLE ARROWHEAD (B-SERIES)

Drawing-No PRODUCTION : Phase

14-0966-001-CSU

Scale 3:4

Project Number

14-0966

Format AH

Sheet 1/1