

CATIA V5

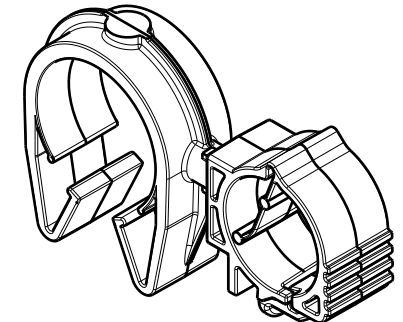
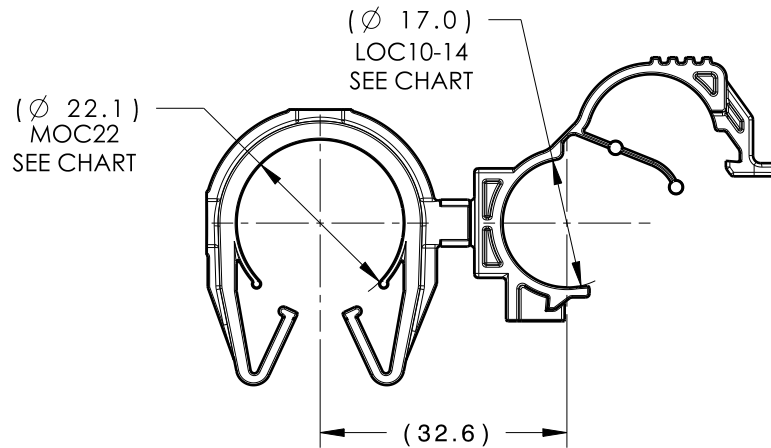
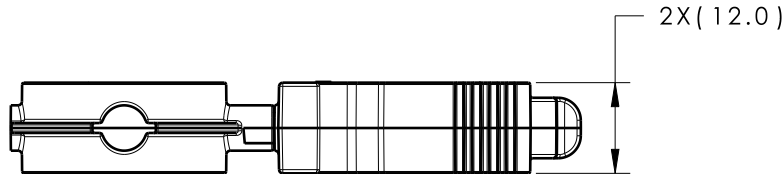
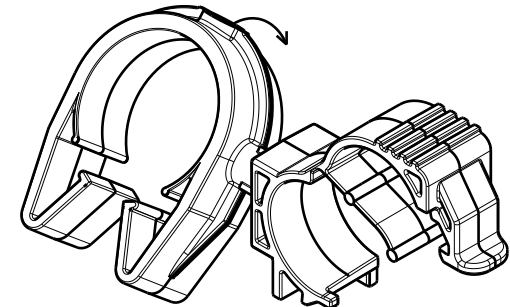

| Revision Level | | | Revision Record | Changed | Date | Approved | Date |
|----------------|----------------|------|-----------------|---------|----------|----------|----------|
| Drawing | State | Part | | | | | |
| 03.1 | Design Release | - | SEE ECN# 015045 | TAT | 4/3/2019 | EJH | 4/3/2019 |

ISOMETRIC VIEW
CLOSEDCLIPS ROTATE
360 DEGREESISOMETRIC VIEW
OPEN

| | |
|----------------|---------------|
| TYPE | MOC22F |
| HARNESS | 20.0MM-24.0MM |
| HOSE | 20.0MM-24.0MM |
| HARD PIPE/TUBE | 22.0MM-25.0MM |

*RECOMMENDED SIZES MAY DIFFER DEPENDING ON THE APPLICATION , PRODUCT REQUIREMENTS AND MATERIALS USED

**PATENT PENDING 29/582,271



GLOBAL PART DESCRIPTION

MOC22FLOC10-14-PA66HIRHSUV-BK

MOC22**

DRAWING

MATERIAL

COLOR

16-0323-000-CSU

PA66HIRHSUV

BLACK

LOC10-14

DRAWING

MATERIAL

COLOR

11-0954-031-CSU

PA66HIRHSUV

BLACK

Material
SEE CHART
COLOR: SEE CHART

Units **millimeters**

Tolerance defined on
each dimension

The copyright of this
drawing is reserved by
HellermannTyton. It is
issued on condition that it is
not reproduced, copied or
disclosed to a third party,
either wholly or in part,
without the consent of
HellermannTyton.

Drawn
Approved

TAT

5/19/17

EJH

5/22/17

HellermannTyton

North America
Email: corp@htamericas.com
Web: www.hellermann.tyton.com

Article/Type-No MOC22FLOC10-14

Title
22MM MOC COUPLED TO 10-14MM LOC

Drawing-No PRODUCTION : Phase

16-0327-222-CSU

Scale 1:1

Project Number
16-0327

Format AH

Sheet
1/1