

SW2015

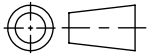

Revision level			Revision Record	Changed	Date	Approved	Date
Drawing	State	Part					
04.1	Design Release	-	SEE ECN# 310154	Johnson	07/25/2023	Gallion	07/28/2023

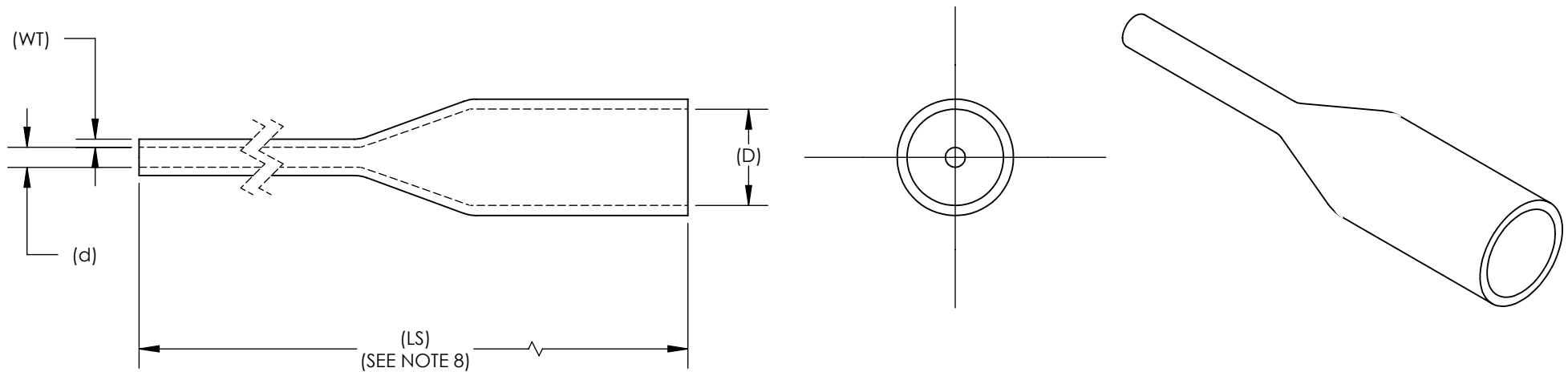

Type	Length Style (LS) A = Reel; B = Stick (See Note 8)	Trade Size	Supplied Diameter (D)		Recovered Diameter (d)		Wall Thickness Recovered (WT)		Color
		in	in	mm	in	mm	in	mm	
TFN31-ST-1.5/0.5 BK	B	1/16	0.063	1.6	0.02	0.5	0.018	0.45	Black
TFN31-ST-3/1 BK	B	1/8	0.125	3.2	0.039	1.1	0.022	0.50	Black
TFN31-3/1 BK	A								
TFN31-ST-4.5/1.5 BK	B	3/16	0.188	4.8	0.059	1.6	0.024	0.60	Black
TFN31-ST-6/2 BK	B	1/4	0.25	6.4	0.079	2.1	0.026	0.65	Black
TFN31-6/2 BK	A								
TFN31-ST-9/3 BK	B	3/8	0.375	9.5	0.118	3.2	0.029	0.75	Black
TFN31-9/3 BK	A								
TFN31-ST-12/4 BK	B	1/2	0.50	12.7	0.157	4.2	0.031	0.80	Black
TFN31-12/4 BK	A								
TFN31-ST-18/6 BK	B	3/4	0.75	19.1	0.236	6.4	0.035	0.90	Black
TFN31-18/6 BK	A								
TFN31-ST-24/8 BK	B	1	1.0	25.4	0.315	8.5	0.047	1.20	Black
TFN31-24/8 BK	A								
TFN31-39/13 BK	A	1 1/2	1.5	39.0	0.512	13.0	0.049	1.25	Black

**NOTES:**

- SHRINK RATIO: 3:1
- LONGITUDINAL CHANGE AFTER SHRINKAGE: -10% to 0%
- MINIMUM SHRINK TEMPERATURE: 158° F (70° C)
- OPERATING TEMPERATURES: -67° F TO 275° F (-55° C TO 135° C)
- DIELECTRIC STRENGTH: >20kV/MM ACCORDING TO ASTM D 150
- FLAMMABILITY: UL 224 VW-1 600V (except clear)
- ECCENTRICITY MAXIMUM: 35%
- CONSULT FACTORY OR WEBSITE FOR AVAILABLE LENGTHS

Material  
POLYOLEFIN, CROSS  
LINKED

Units: inches

Dimension without  
tolerances details to:  
.xxxx = ±.0005  
.xxx = ±.005  
.xx = ±.01  
.x = ±.03  
None = ±.06  
∠ = ±0.5°  
Dimension Formatted in [mm]

The copyright of this  
drawing is reserved by  
HellermannTyton. It is  
not reproduced, copied, or  
disclosed to a third party,  
either wholly or in part,  
without the consent of  
HellermannTyton.

Drawn GRW 11/7/2016  
Approved KAC 11/7/2016  
**HellermannTyton**  
Web: [www.HellermannTyton.com](http://www.HellermannTyton.com)

Article/Type-No TFN31 SERIES  
Title **HEAT SHRINK TUBING, 3:1 SHRINK  
RATIO, NON-ADHESIVE THIN WALL  
TUBING**  
Drawing-No PRODUCTION : Phase  
**16-1635-001-CSU**

Scale  
Project Number  
PRP 16-1635  
Format AH  
Sheet 1/1