

CONFIGURATION 1 SHOWN
PRODUCT SHIPPED IN CLAMP OPEN POSITION

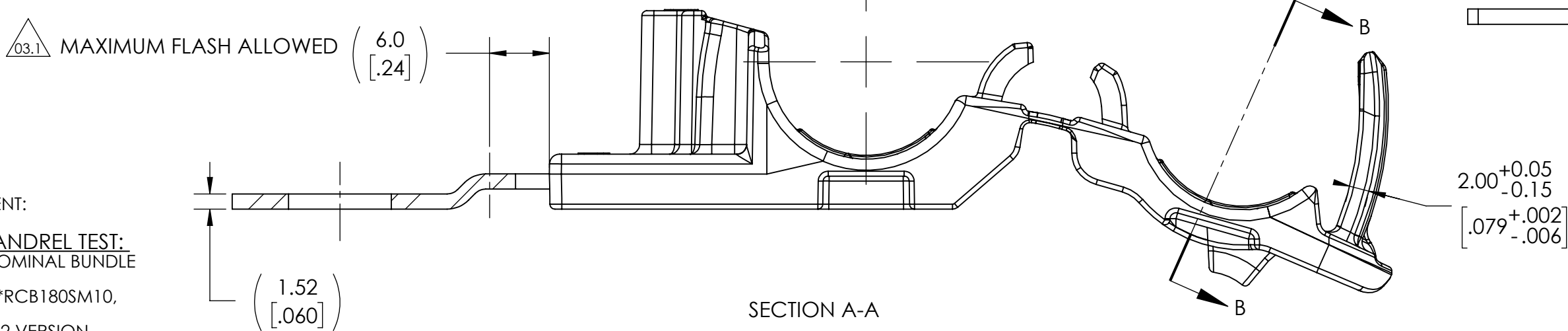
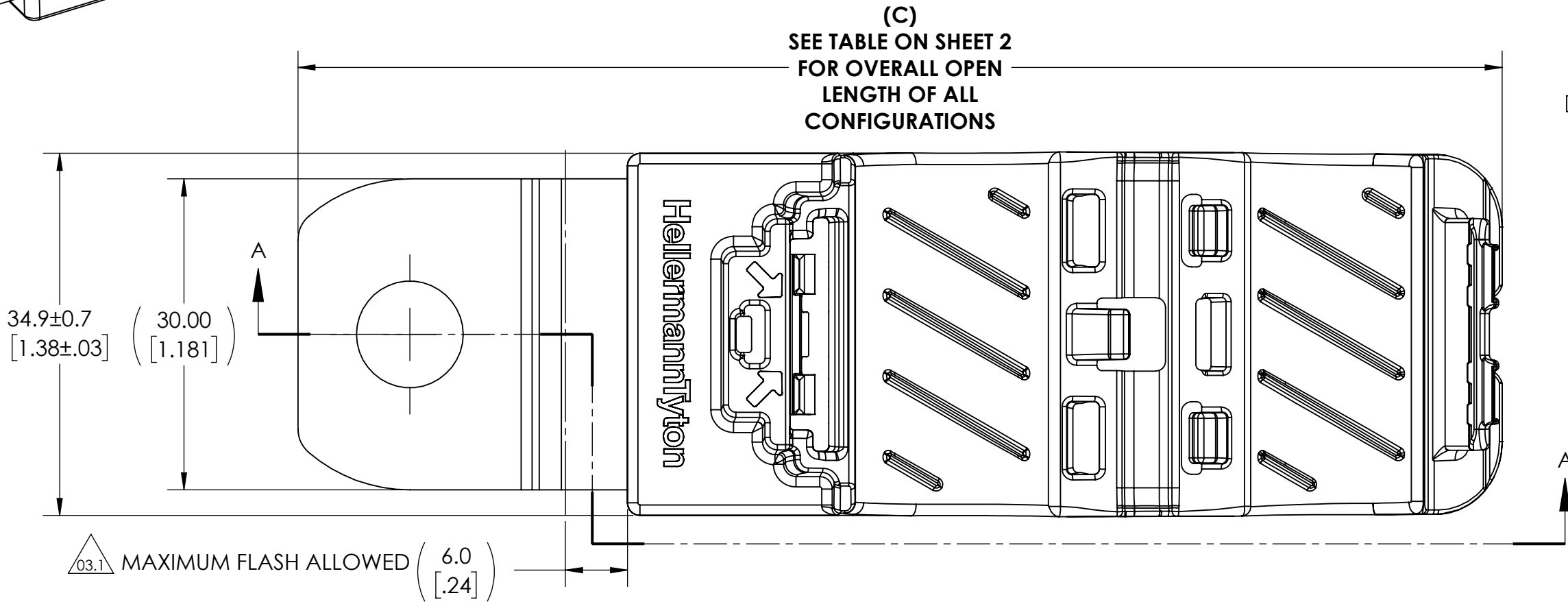

INITIAL MOLD VALIDATION:
DRY AS MOLDED WITH $\leq 0.5\%$ MOISTURE CONTENT:

1. ITS-0003 RATCHET P CLAMP SOLID MANDREL TEST:
EXCEEDED 445 NEWTONS (100 LBS) MIN AT A NOMINAL BUNDLE DIAMETER OF 15.88 [0.625]
TESTING ONLY REQUIRED OF CONFIGURATION *RCB180SM10, *RCB180LM10, AND *RCB90LM10
*TESTING CAN BE SUBSTITUTED WITH M6, M8, M12 VERSION MOUNTING HOLES

2. ITS-0008 CLOSE AND RELEASE TEST:
EXCEEDED 445 NEWTONS (100 LBS) MIN AT A NOMINAL BUNDLE DIAMETER OF 15.88 [0.625] AFTER CLOSING AND RELEASING 40 TIMES

3. ITS-0014 LOW TEMPERATURE HINGE TEST:
NO DAMAGE OCCURED AFTER BENDING LIVING HINGE 40 TIMES AT -40°C

NOTE: TESTING #2 AND #3 CAN BE DONE ON ANY TYPE NUMBER AND WILL APPLY TO ALL OTHER TYPE NUMBERS IN THE TABLE ON SHEET 2

PERFORMANCE REQUIREMENTS:
DRY AS MOLDED WITH $\leq 0.5\%$ MOISTURE CONTENT:

4. ITS-0001 RATCHET P CLAMP SPLIT MANDREL TEST:
445 NEWTONS (100 LBS) MIN AT A NOMINAL BUNDLE DIAMETER OF 15.88 [0.625]

NOTE: TESTING CAN BE DONE ON ANY TYPE NUMBER AND WILL APPLY TO ALL OTHER TYPE NUMBERS IN THE TABLE ON SHEET 2

5. MAXIMUM PERCENT REGRIND PERMISSABLE: 25%
6. MAXIMUM ALLOWABLE FLASH OR MISMATCH TO BE: 0.25mm

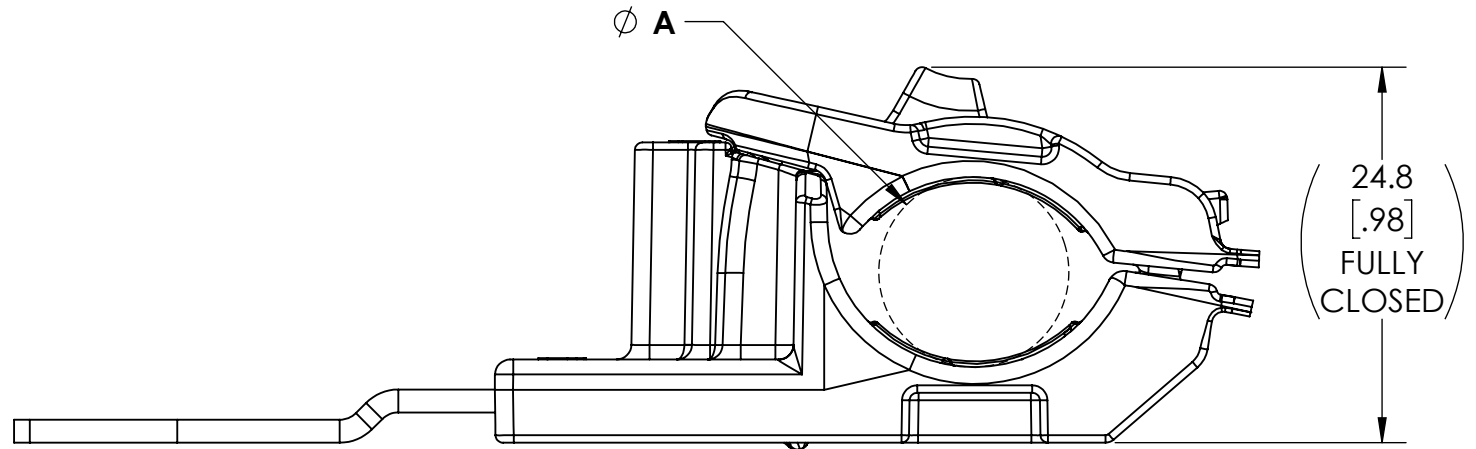
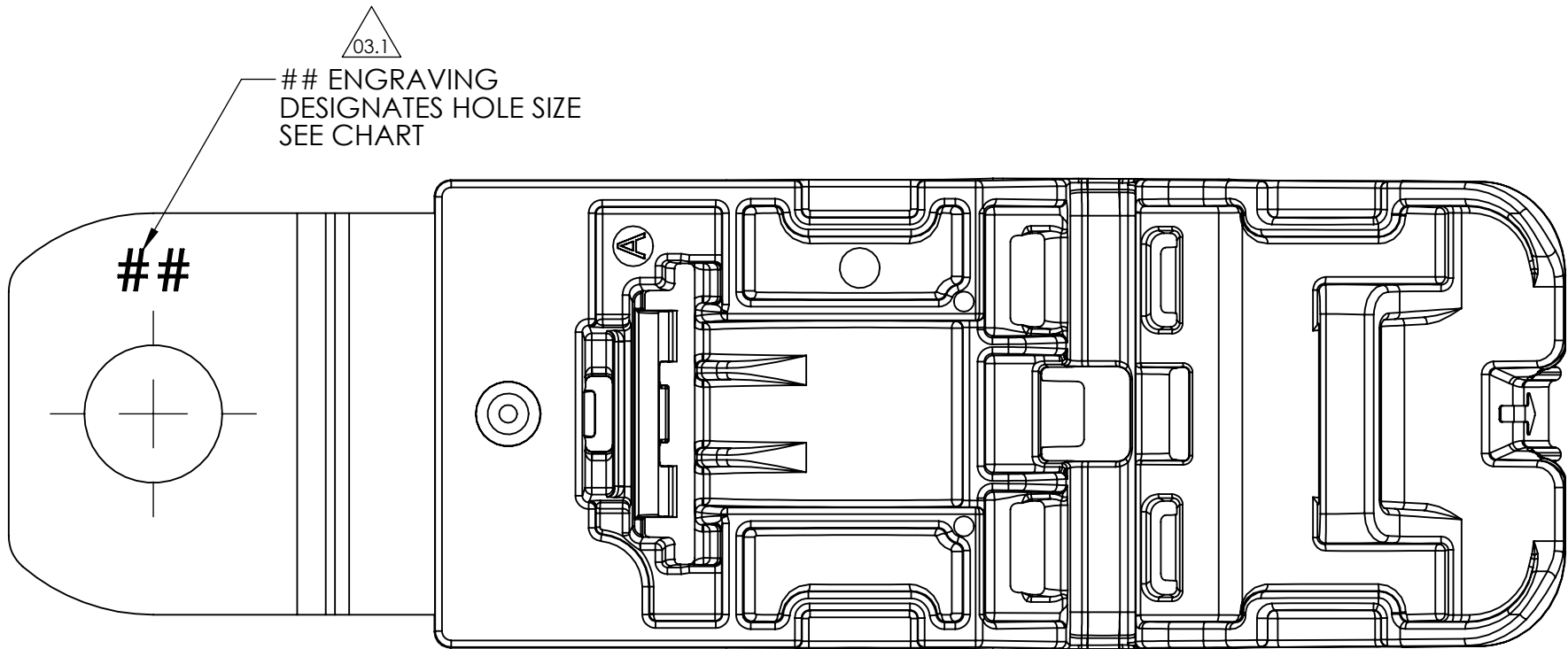

MINIMUM BUNDLE DIAMETER

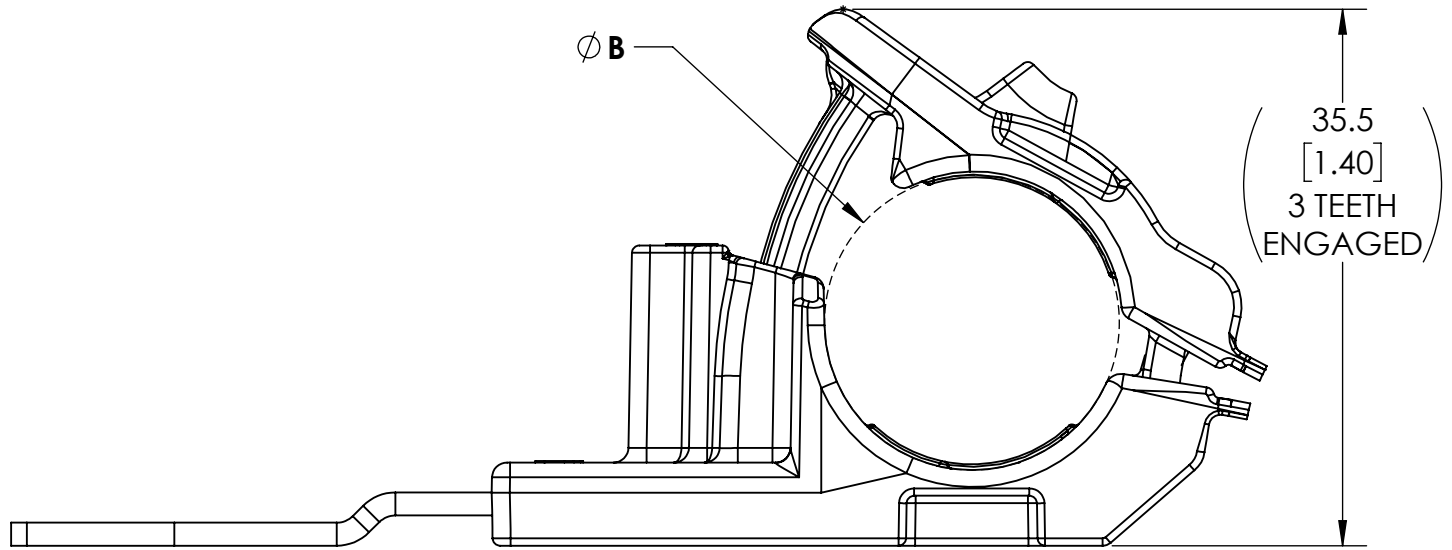

MAXIMUM BUNDLE DIAMETER

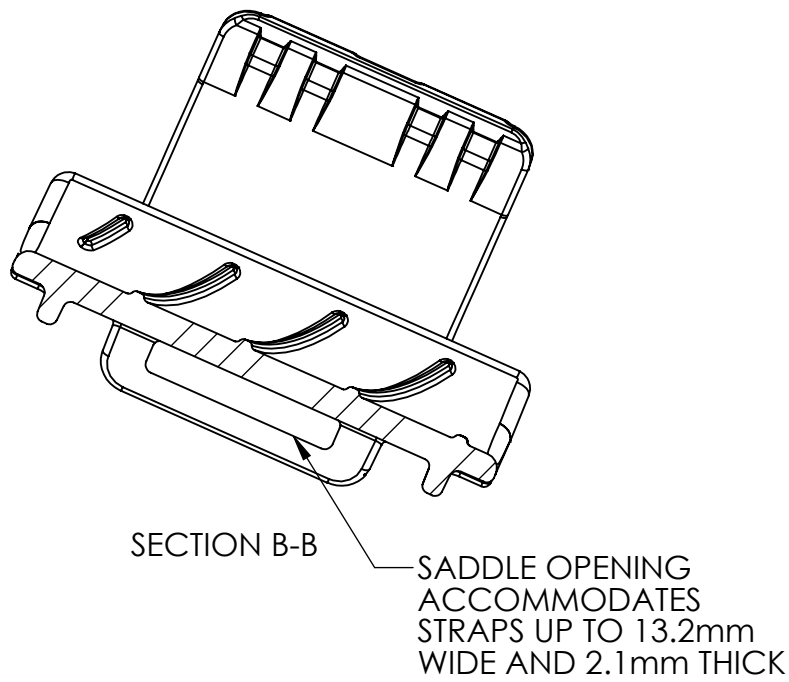

BUNDLE TYPES	A MINIMUM DIAMETER	B MAXIMUM DIAMETER
SOFT	12.7 [.50]	19.5 [.77]
HARD	11.9 [.47]	18.7 [.74]

Notes	Material	Units: millimeters Dimension without tolerances details to: .XXX = ±.013 .XX = ±.13 .X = ±.3 None = ±.8 ≤ = ±0.5* Dimension Formatted mm[.in]	The copyright of this drawing is reserved by HellermannTyton. It is issued on condition that it is not reproduced, copied, or disclosed to a third party, either wholly or in part, without the consent of HellermannTyton.	Drawn	MHT	08/14/2017	Article/Type-No	SEE CHART (SHEET 2)	Scale	2:1
				Approved	KAC	08/18/2017	Title	RCB RATCHET P CLAMP, SIZE B, CLAMP RANGE 12.7 TO 19.5, E-COAT STEEL	Project Number	PRP17-1572
				<div>HellermannTyton</div> <div>North America Email: corp@htamericas.com Web: www.hellermann.tyton.com</div>			Drawing-No	PRODUCTION: Phase	Format	C
							17-1572-101-CSU			Sheet

