

| SYMBOL DEFINITION  |                                   |    | MISSING SYMBOLS           |         |                | Revision Level |                 |  | Revision Record |     |          | Changed | Date     | Approved | Date |
|--|-----------------------------------|----|---------------------------|---------|----------------|----------------|-----------------|--|-----------------|-----|----------|---------|----------|----------|------|
| A DIMENSION WITHOUT AN INSPECTION REPORT SYMBOL  DOES NOT REQUIRE INSPECTION. IT MAY BE CONTROLLED ON THE INDIVIDUAL COMPONENT DRAWING. | TOTAL NO. OF INSPECTIONS REQUIRED | 16 | NO MISSING SYMBOL NUMBERS | Drawing | State          | Part           | SEE EGN# 014085 |  |                 | RJE | 08/16/17 | EJH     | 08/16/17 |          |      |
|  | LAST NO. USED                     | 16 |                           | 24.0    | Design Release |                |                 |  |                 |     |          |         |          |          |      |
|  |                                   |    |                           |         |                |                |                 |  |                 |     |          |         |          |          |      |

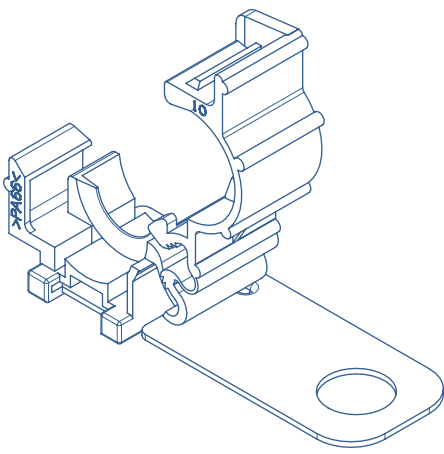

ISOMETRIC VIEW

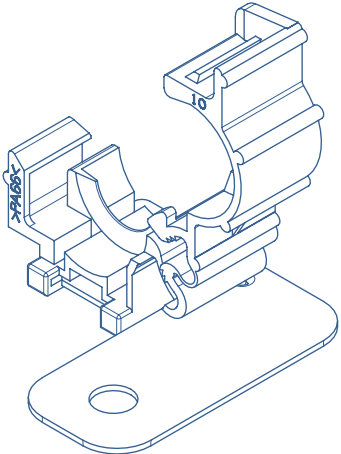

ISOMETRIC VIEW

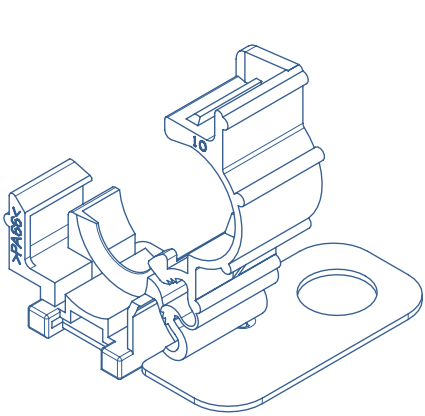

ISOMETRIC VIEW

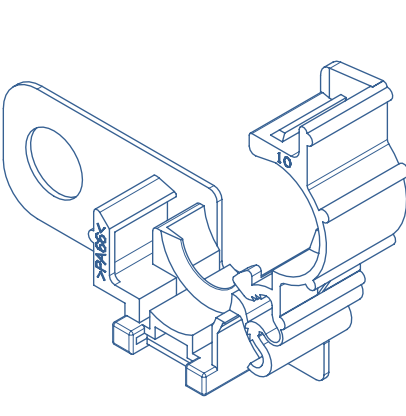

ISOMETRIC VIEW

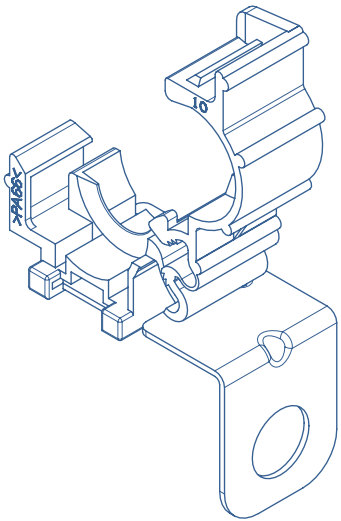

ISOMETRIC VIEW

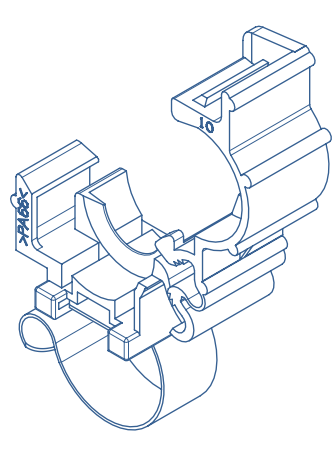

ISOMETRIC VIEW

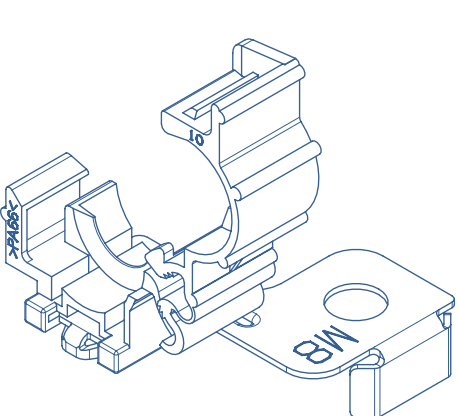

ISOMETRIC VIEW

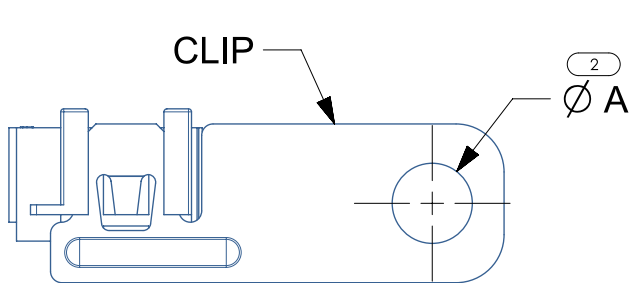
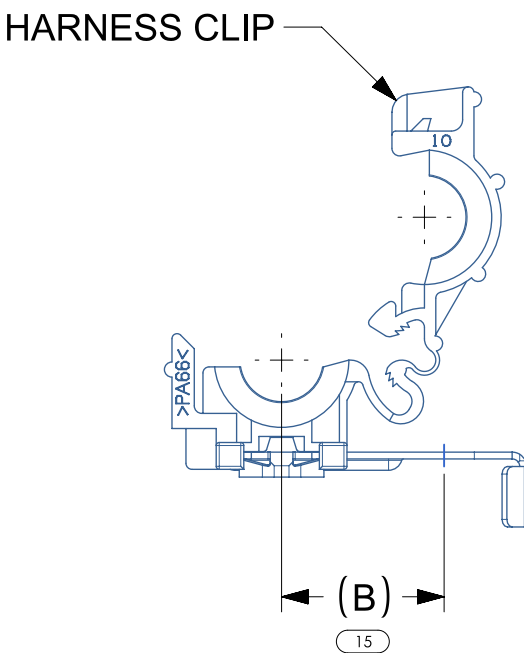
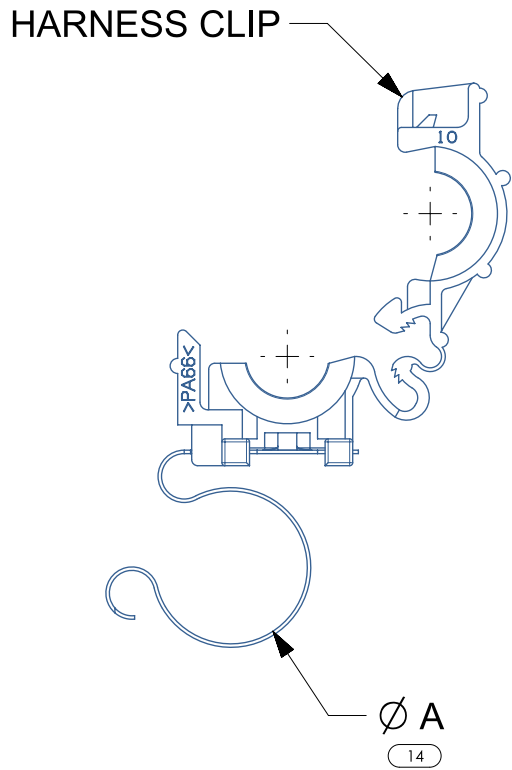
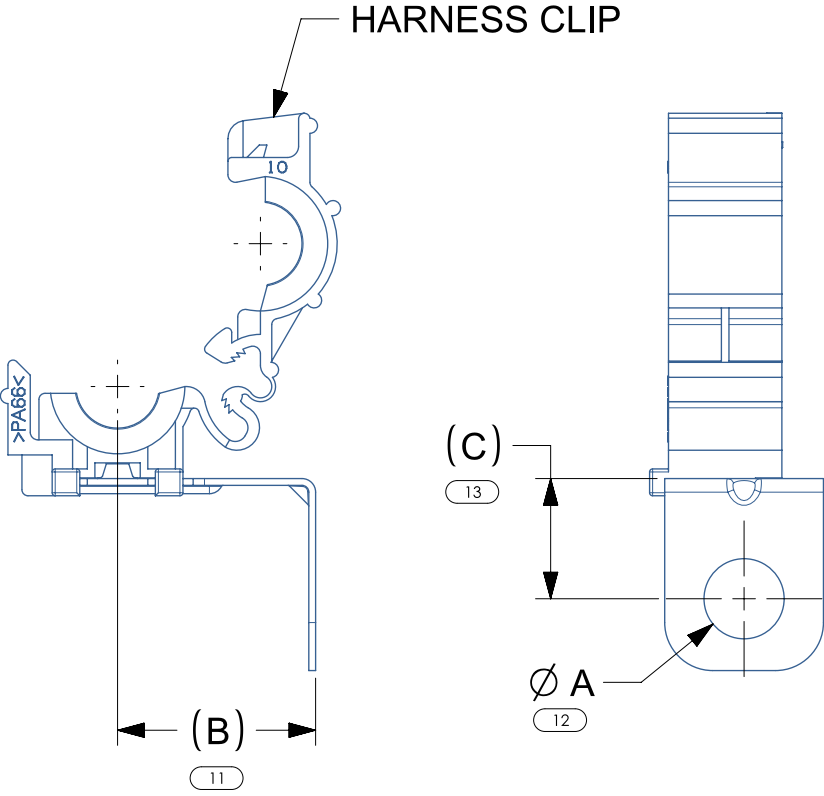
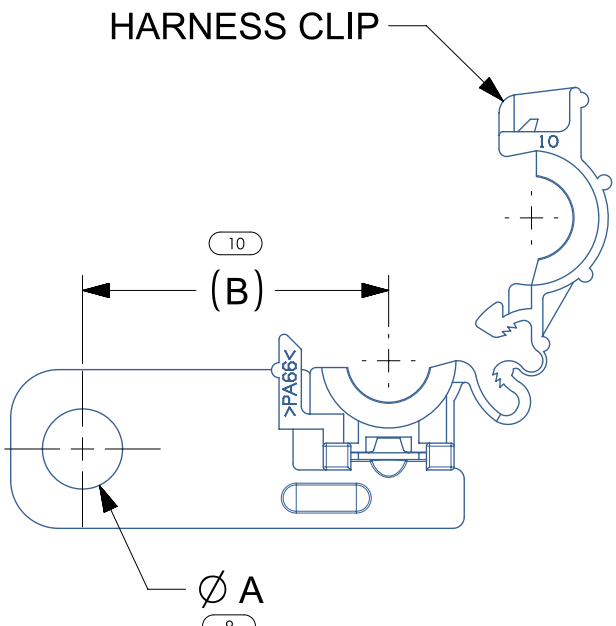
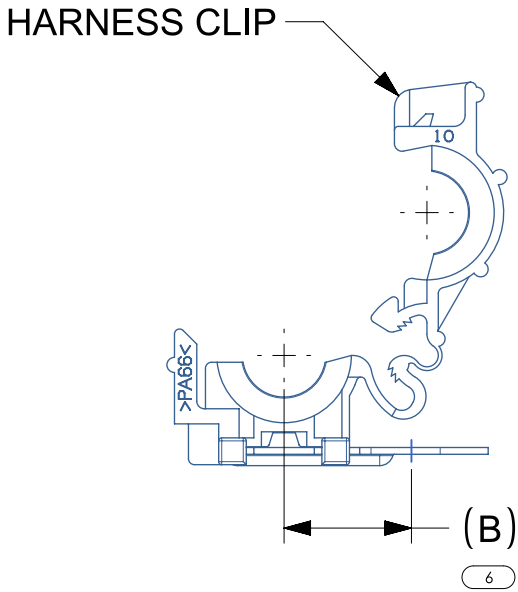
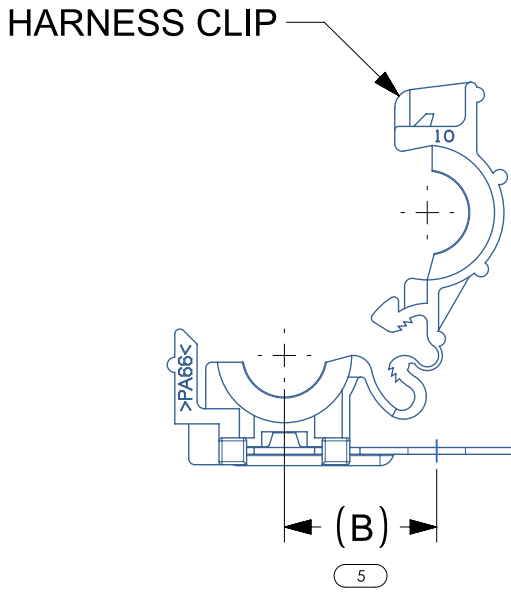
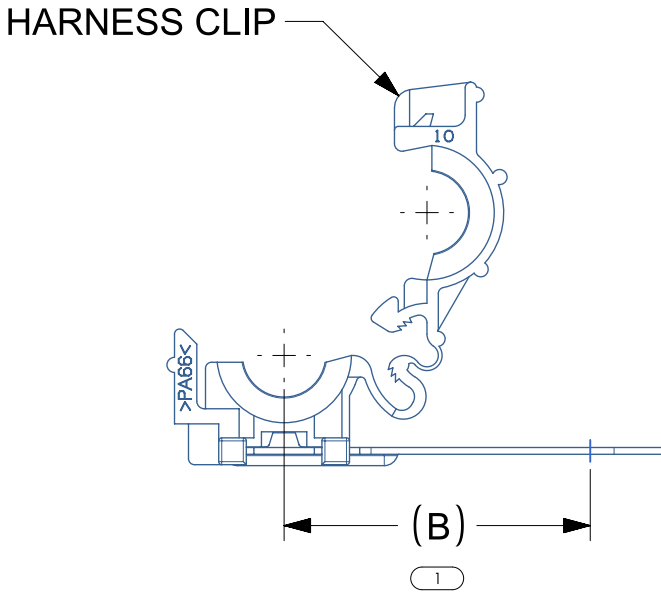

TYPE 101

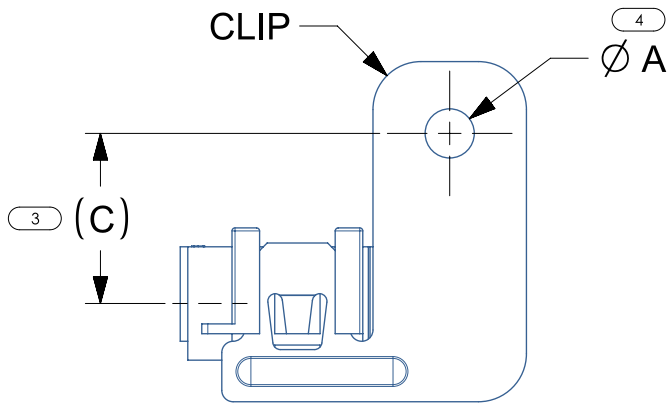

TYPE 102

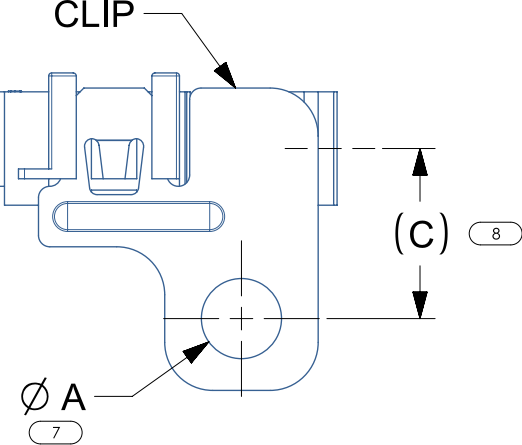

TYPE 103

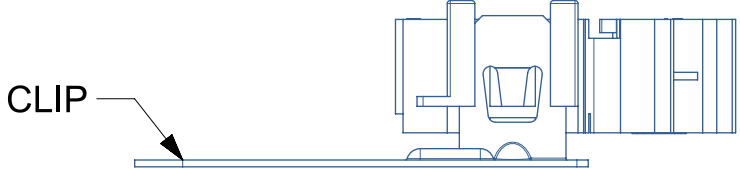

TYPE 104

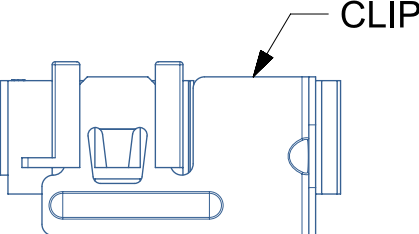

TYPE 105

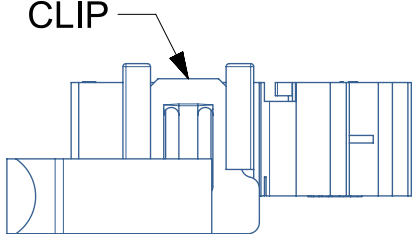

TYPE 106

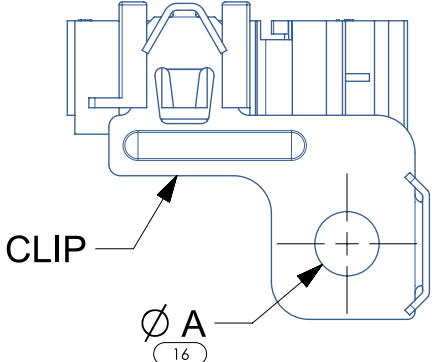

TYPE 107

NOTES:

1. UNLESS OTHERWISE SPECIFIED AND/OR INDICATED:

DIMENSIONS ARE TO FACE OF VIEW SHOWN AND AUTOMATICALLY ROUNDED BY COMPUTER FOR INSPECTION (SEE MATH MODEL FOR PRECISE DIMENSIONS). FOR ALL OTHER DIMENSIONS NOT SHOWN, BUT RECUIRED FOR TOOL BUILD, SEE MATH MODEL FOR PRECISE TOOL PATH DATA.

2. OBSOLETE PART(S) CONTAIN A HEXAVALENT CHROME COATING, DO NOT USE THIS PART ON NEW APPLICATIONS, HEXAVALENT CHROME IS A BAND SUBSTANCE. IF THIS PART IS REQUIRED FOR CURRENT OR FUTURE BUSINESS OR FOR SERVICE REQUIREMENTS, CONTACT THE PRODUCT LINE ENGINEER OF MATERIALS ENGINEERING TO GET A NEW PART THAT IS FREE FROM HEXAVALENT CHROME. JULY 1, 2007 FOR SERVICE REQUIREMENTS.

3. THIS PRODUCT IS NOT CATEGORIZED AS AN APPEARANCE ITEM. MINOR IMPERFECTIONS INCLUDING, BUT NOT LIMITED TO, FLOW MARKS, COLOR BLEMISHES, GATE VESTIGES, AND SOFT FLASH THAT DO NOT AFFECT THE FIT, FORM, OR FUNCTION OF THE PART ARE PERMISSIBLE PER SPEC: S-QA-10.3-9

| TYPE | ASSY    | PART NUMBER | HARNESS CLIP | CLIP     | MOUNTING BOLT | Ø A                                  | B     | C    |
|------|---------|-------------|--------------|----------|---------------|--------------------------------------|-------|------|
| 101  | 17-2096 | 15495737    | 15304667     | 15477653 | M10           | 10.6±0.1                             | 40.5  |      |
| 101  | 17-2099 | 15495767    | 15304667     | 15477665 | M6            | 6.5±0.1                              | 40.5  |      |
| 102  | 17-2093 | 13548354    | 15304667     | 15477659 | M6            | 6.5±0.1                              | 20.15 | 22.0 |
| 103  | 17-2094 | 13729312    | 15304667     | 15477666 | M10           | 10.6±0.1                             | 16.85 | 22.0 |
| 104  | 17-2098 | 15495761    | 15304667     | 15477664 | M10           | 10.6±0.1                             | 40.5  |      |
| 105  | 17-2097 | 15495756    | 15304667     | 15477660 | M10           | 10.6±0.1                             | 26.2  | 15.9 |
| 106  | 17-2095 | 13763471    | 15304667     | 15495861 |               | 20.2 <sup>+0.3</sup> <sub>-0.7</sub> |       |      |
| 106  | 17-2101 | 15495852    | 15304667     | 15477647 |               | 25.0 <sup>+0.3</sup> <sub>-0.7</sub> |       |      |
| 107  | 17-2100 | 15495835    | 15304667     | 15477671 | M8            | 8.5±0.1                              | 21.5  |      |

DIMENSIONS ENCLOSED IN ( ) INDICATE REFERENCE DIMENSIONS AND NO TOLERANCE LIMITS ARE ESTABLISHED.

|                       |  |  |                      |  |  |  |  |  |                                 |  |  |                      |  |  |                                   |  |  |                                   |  |  |
|-----------------------|--|--|----------------------|--|--|--|--|--|---------------------------------|--|--|----------------------|--|--|-----------------------------------|--|--|-----------------------------------|--|--|
| Material<br>SEE CHART |  |  | Units<br>millimeters |  |  | The copyright of this drawing is reserved by HellermannTyton. It is issued on condition that it is not reproduced, copied or disclosed to a third party, either wholly or in part, without the consent of HellermannTyton. |  |  | Drawn<br>Approved<br>RJE<br>EJH |  |  | 08/16/17<br>08/16/17 |  |  | Article/Type-No<br>SEE CHART      |  |  | Scale<br>1:1                      |  |  |
|                       |  |  |                      |  |  |  |  |  |                                 |  |  |                      |  |  | Title<br>TAXI ASM MOUN CLIP - CDT |  |  | Project Number<br>17-2093         |  |  |
|                       |  |  |                      |  |  |  |  |  |                                 |  |  |                      |  |  | Drawing-No<br>17-2093-001-CSU     |  |  | PRODUCTION : Phase<br>Format<br>D |  |  |
|                       |  |  |                      |  |  |  |  |  |                                 |  |  |                      |  |  |                                   |  |  | Sheet<br>1 / 1                    |  |  |