



Fixing Elements for Corrugated Tubing, for Weld Studs

CTC-Series for Weld Studs

These holders are used in the automotive industry, in the production of cable harnesses and in the electrical industry. Their quick and easy mounting is the reason for their universal success wherever corrugated tubing and pipes have to be fixed quickly and securely.

Features and benefits

- Fixing elements for corrugated tubing for nominal diameters from 4.5 - 17.0 mm
- For M6 weld studs
- Soft-Push mechanic for simple assembly, without tool
- Tube is guided accurately by clicking
- Axial slipping is prevented by the inside profile of the clamp
- Clamp can be unscrewed and removed from the weld stud



The tubing is clicked into the CTC clamp and is held firmly.

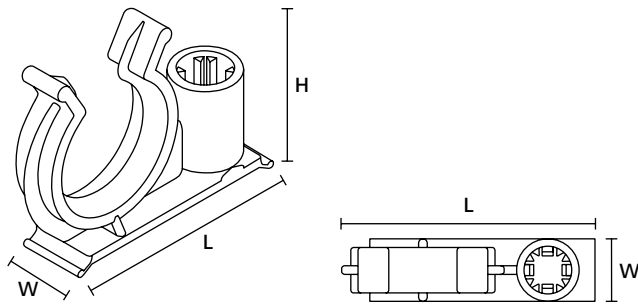

CTC()SB56



Material specification
please see page 22.

TYPE	Drawing	Width (W)	Length (L)	Height (H)	Nominal Ø	Stud Ø	Material	Colour	Article-No.
CTC4.5SB56		11.0	28.6	18.7	4.5	6.0	PA66HIRHS	Black (BK)	151-00700
CTC7.5SB56		11.0	31.8	19.4	7.5	6.0	PA66HIRHS	Black (BK)	151-00701
CTC10SB56		11.0	35.3	22.2	10.0	6.0	PA66HIRHS	Black (BK)	151-00702
CTC13SB56		11.0	37.0	26.5	13.0	6.0	PA66HIRHS	Black (BK)	151-00703
CTC17SB56		11.0	44.6	33.2	17.0	6.0	PA66HIRHS	Black (BK)	151-00010

All dimensions in mm. Subject to technical changes.