



#### 4-Way Outlet Shapes, Breakout Boots

- Helashrink 400 Series, in line, low voltage

##### Features and Benefits

- Easy, time-saving insulation of cable branch point where it splits into single wires
- Made of tough, cross-linked, Polyolefin
- Adhesive to relieve mechanical tension in cable harnesses

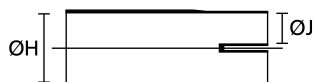

a: Expanded form (supplied)

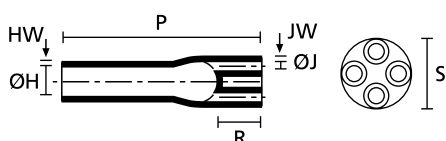

b: Fully recovered form (after heating)



400 series supplied / fully recovered.

TYPE	ØH min. a	ØH max. b	ØJ min. a	ØJ max. b	P ± 10%	R ± 10%	HW ± 20%	JW ± 20%	S nom.	Article-No.
442-1-B8WM250	28.0	9.0	9.0	1.8	78.0	17.0	2.7	2.0	20.0	404-42009
408-2-B8W2	35.0	12.0	15.0	3.0	95.0	24.0	2.5	2.0	22.0	404-08022
409-2-B8W2	47.4	22.9	21.5	6.4	165.0	38.1	4.1	3.3	38.1	404-09021
418-4-B8W2	60.0	22.9	30.0	6.4	202.0	38.1	4.1	3.3	38.1	404-18020
444-2-B8W2	95.0	35.6	35.6	12.5	240.0	55.0	4.0	3.5	50.8	404-44022

All dimensions in mm. Subject to technical changes.

For these moulded shapes a wide range of material / adhesive combinations are available. Please refer to the moulded shapes catalogue.

#### 5-Way Outlet Shapes, Breakout Boots

- Helashrink 500 Series, in line, low voltage

##### Features and Benefits

- Cable breakout boots for insulating and sealing cable crotch or conduit system
- Excellent resistance to abrasion and weathering

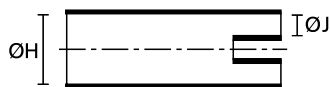

a: Expanded form (supplied)

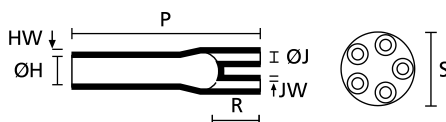

b: Fully recovered form (after heating)



500 Series supplied / fully recovered.

TYPE	ØH min. a	ØH max. b	ØJ min. a	ØJ max. b	P ± 10%	R ± 10%	HW ± 20%	JW ± 20%	S nom.	Article-No.
508-3-B7	89.0	24.5	33.0	7.5	180.0	30.0	3.5	3.0	48.0	405-08036
508-3-B7W	89.0	24.5	33.0	7.5	180.0	30.0	3.5	3.0	48.0	405-08035

All dimensions in mm. Subject to technical changes.

For these moulded shapes a wide range of material / adhesive combinations are available. Please refer to the moulded shapes catalogue.